

NAKAMURA

NTJ-100

Super NTMX

Super NTY 3





WT-100

WY-100

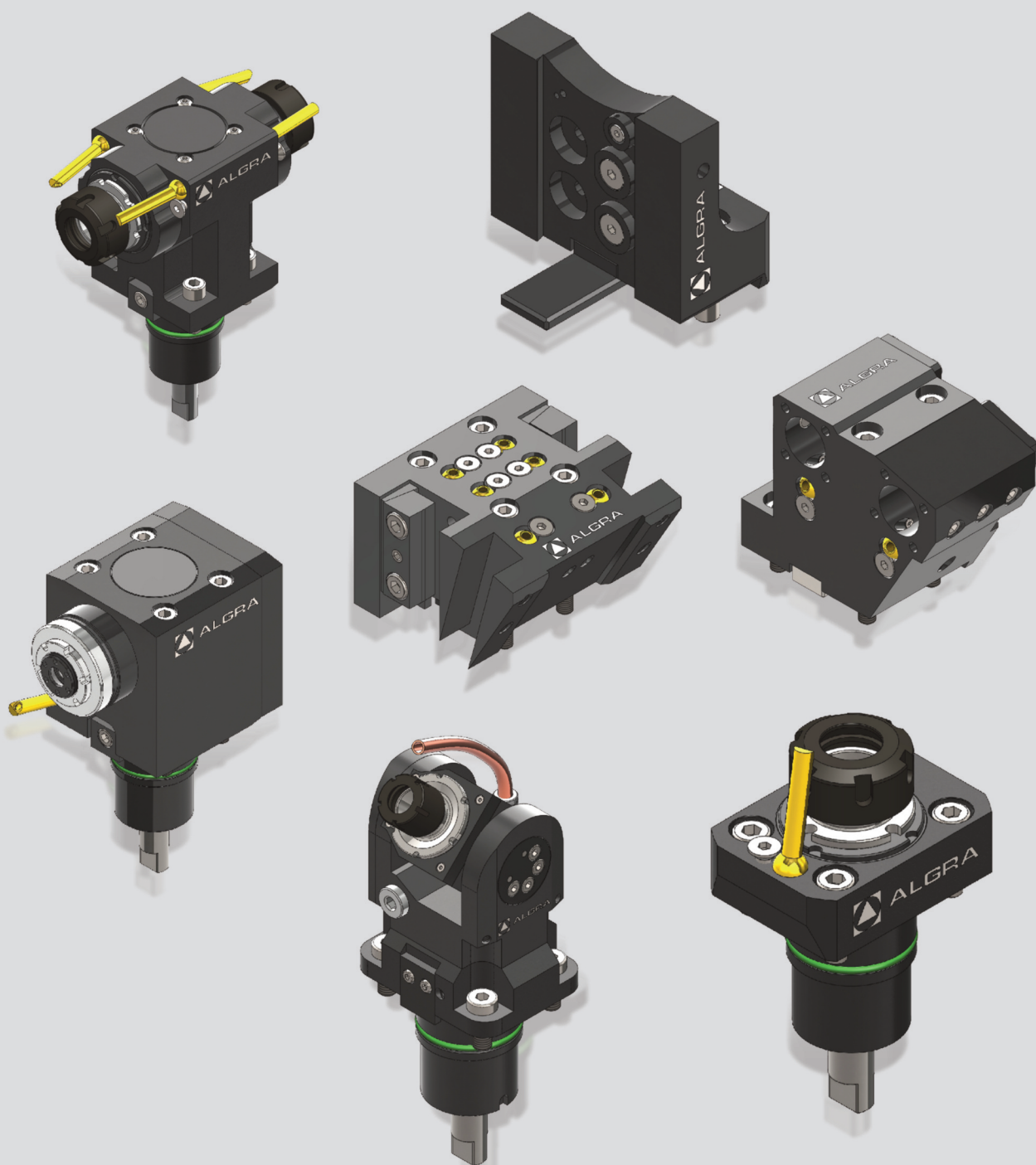
Toolholder Program

N44



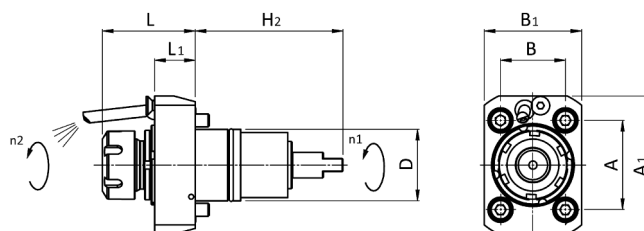

N44	Version	Tools Clamping	Center Height	Max. speed	Ratio	External	Internal	Page
	0°	ER25 - DIN6499		6000rpm	i=1:1	RAPPS 25 121UN44	RAPPS 25 131UN44	4
	90°	ER25 - DIN6499 ER25 - DIN6499	60mm 75mm	6000rpm 6000rpm	i=1:1 i=1:1	RRPPS 25 121UN44 RRPPS 25 321UN44	RRPPS 25 131UN44 RRPPS 25 331UN44	5 5
	90° Double	ER25 - DIN6499 ER25 - DIN6499	60mm 75mm	6000rpm 6000rpm	i=1:1 i=1:1	RRPPT 25 121UN44 RRPPT 25 321UN44		6 6
	±90°	ER16 - DIN6499		6000rpm	i=1:1	ROPPS 16 121UN44	ROPPS 16 131UN44	7

N44	Version	Tools Clamping	Center Height	Coolant	ALGRA Part No.	Page
	O.D. cutting holder	□ 20mm	H:62mm	Ext. Coolant	E10/US 20 N44X62	8
		□ 0.75"	H:62mm	Ext. Coolant	E10/US 0.75" N44X62	8
	Cut-off holder	□ 20mm	H:62mm	Ext. Coolant	E10/UL 20 N44X62	8
		□ 0.75"	H:62mm	Ext. Coolant	E10/UL 0.75" N44X62	8
	O.D. double holder	□ 20mm	H:62mm	Ext. Coolant	E10/UD 20 N44X62	9
		□ 0.75"	H:62mm	Ext. Coolant	E10/UD 0.75" N44X62	9
	Double Cut-off holder	□ 20mm	H:62mm	Ext. Coolant	E10/ULD20 N44X62	9
		□ 0.75"	H:62mm	Ext. Coolant	E10/ULD0.75" N44X62	9
	Face and I.D. cutting holder	□ 20mm	H:60mm	Ext. Coolant	E10/UA 20 N44X60	10
		□ 0.75"	H:60mm	Ext. Coolant	E10/UA 0.75" N44X60	10
	Blade holder	∥ 26mm	H:70mm	Ext. Coolant	E10/TT 26 N44X70	10
		∥ 32mm	H:70mm	Ext. Coolant	E10/TT 32 N44X70	10
	Blade holder	∥ 26mm	H:66mm	Ext. Coolant	E10/TTN26 N44X66	11
		∥ 32mm	H:66mm	Ext. Coolant	E10/TTN32 N44X66	11
	Index cutting holder	□ 20mm	H:65mm	Ext. Coolant	E12/IDD20 N44X65	11
		□ 0.75"	H:65mm	Ext. Coolant	E12/IDD0.75" N44X65	11
	Index cutting holder	□ 20mm	H:65mm	Ext. Coolant	E12/IDS20 N44X65	12
		□ 0.75"	H:65mm	Ext. Coolant	E12/IDS0.75" N44X65	12
	Index cutting holder	□ 20mm	H:65mm	Ext. Coolant	E12/IQ 20 N44X65	12
		□ 0.75"	H:65mm	Ext. Coolant	E12/IQ 0.75" N44X65	12
	Boring Bar holder	∅ 25mm	H:60mm	Int/Ext Coolant	E10/B 25 N44X60	13
		∅ 32mm	H:60mm	Int/Ext Coolant	E10/B 32 N44X60	13
		∅ 20mm	H:75mm	Int/Ext Coolant	E10/B 20 N44X75	13
		∅ 25mm	H:75mm	Int/Ext Coolant	E10/B 25 N44X75	13
		∅ 32mm	H:75mm	Int/Ext Coolant	E10/B 32 N44X75	13
		∅ 1"	H:75mm	Int/Ext Coolant	E10/B 1" N44X75	13
	Index Boring Bar holder	∅ 25mm	H:75mm	Int/Ext Coolant	E12/IBD25 N44X75	13
		∅ 1"	H:75mm	Int/Ext Coolant	E12/IBD1" N44X75	13





1/N			Codice code - code - Bestell Nr.	D	ER	H	H1	H2	L (min-max)	L1	L2	A	B	A1	B1	A2	B2	M ₂ Nm	n ₂ min-1	P kW
0°			RAPPS 25 121UN44	44	25			91	53,5÷57,2	25		55	40	85	60			40	6000	6



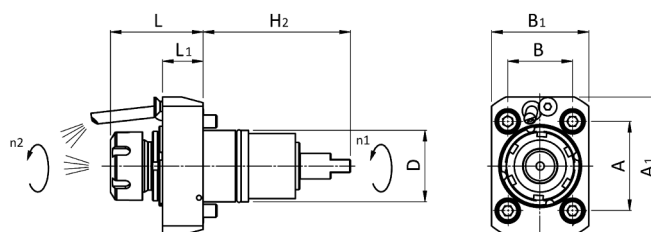







2/N			Codice code - code - Bestell Nr.	D	ER	H	H1	H2	L (min-max)	L1	L2	A	B	A1	B1	A2	B2	M ₂ Nm	n ₂ min-1	P kW
0°			RAPPS 25 131UN44	44	25			91	53,5÷57,2	25		55	40	85	60			40	6000	6





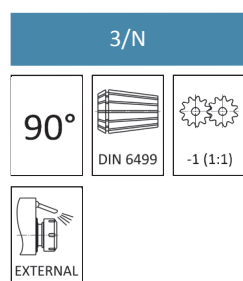
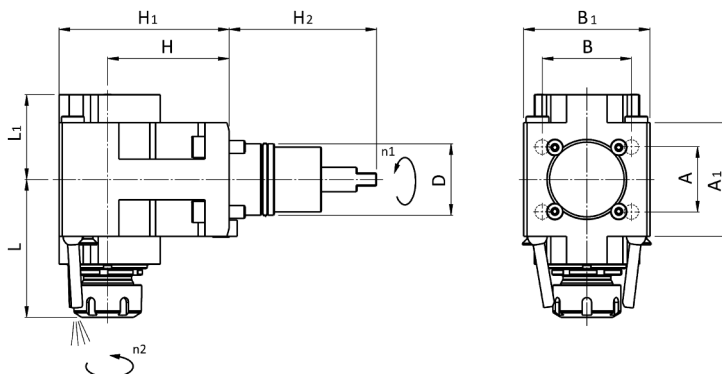

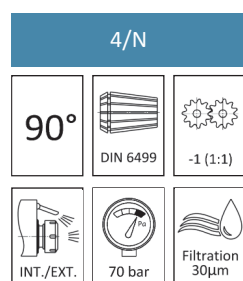
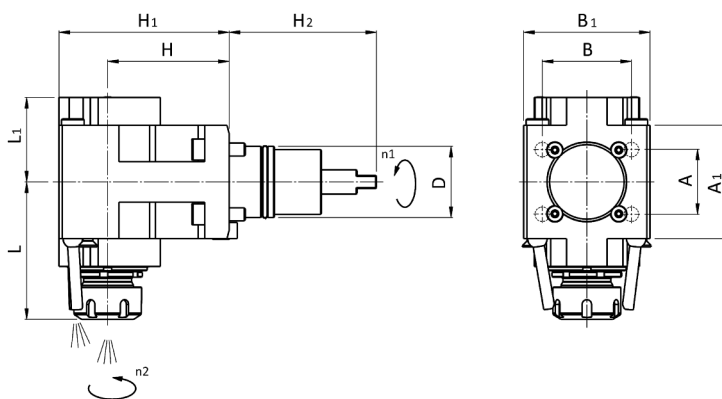

Codice code - code - Bestell Nr.	D	ER	H	H1	H2	L (min-max)	L1	L2	A	B	A1	B1	A2	B2	M ₂ Nm	n ₂ min-1	P kW
RRPPS 25 121UN44	44	25	60	90	91	81,2÷84,9	52,2		40	55	70	78			40	6000	6
RRPPS 25 321UN44	44	25	75	105	91	81,2÷84,9	52,2		40	55	70	78			40	6000	6

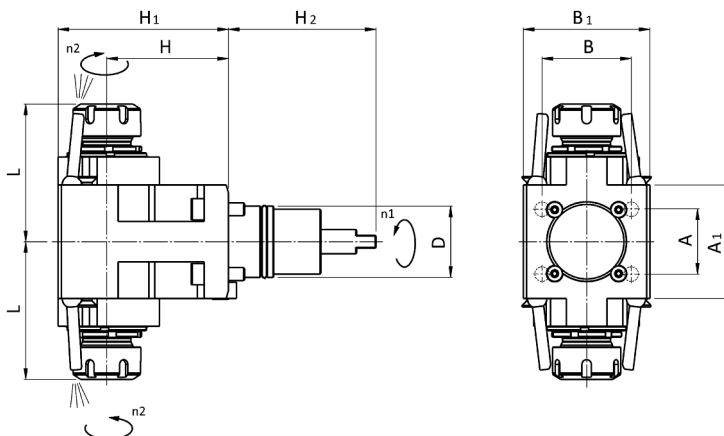
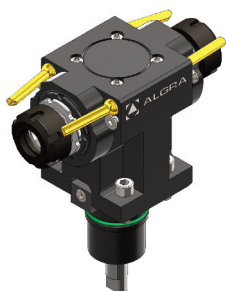

Codice code - code - Bestell Nr.	D	ER	H	H1	H2	L (min-max)	L1	L2	A	B	A1	B1	A2	B2	M ₂ Nm	n ₂ min-1	P kW
RRPPS 25 131UN44	44	25	60	90	91	81,2÷84,9	52,2		40	55	70	78			40	6000	6
RRPPS 25 331UN44	44	25	75	105	91	81,2÷84,9	52,2		40	55	70	78			40	6000	6

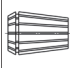

5/N			Codice code - code - Bestell Nr.	D	ER	H	H1	H2	L (min-max)	L1	L2	A	B	A1	B1	A2	B2	M ₂ Nm	n ₂ min-1	P kW
90°			RRPPT 25 121UN44	44	25	60	90	91	81,2-84,9			40	55	70	78			40	6000	6
			RRPPT 25 321UN44	44	25	75	105	91	81,2-84,9			40	55	70	78			40	6000	6
																				

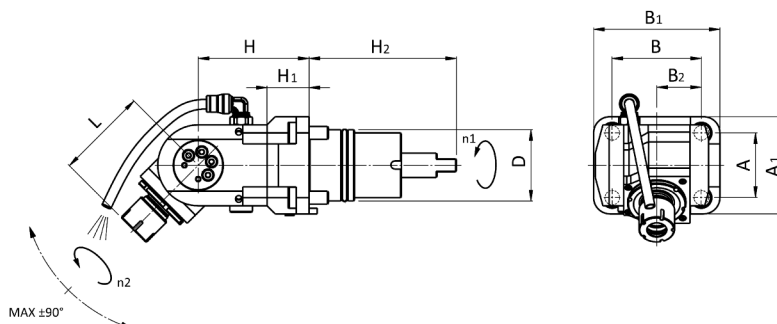

6/N



Codice code - code - Bestell Nr.	D	ER	H	H1	H2	L (min-max)	L1	L2	A	B	A1	B1	A2	B2	M ₂ Nm	n ₂ min-1	P kW
ROPPS 16 121UN44	44	16	68,5	26	91	52,8-56,5			40	55	60	78		27,5	10	6000	2

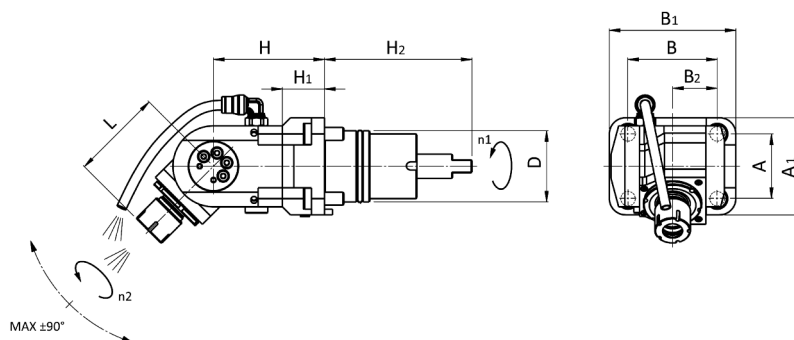

7/N

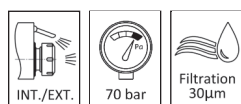

Codice code - code - Bestell Nr.	D	ER	H	H1	H2	L (min-max)	L1	L2	A	B	A1	B1	A2	B2	M ₂ Nm	n ₂ min-1	P kW
ROPPS 16 131UN44	44	16	68,5	26	91	52,8-56,5			40	55	60	78		27,5	10	6000	2

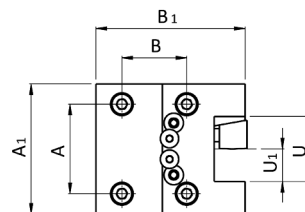
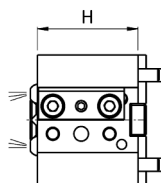
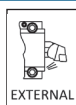
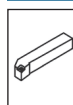
101/N44

Codice code - code - Bestell Nr.	U	U1	U2	U3	H	H1	H2	H3	A	B	A1	B1	A2	B2	B3
E10/US 20 N44X62	40	20			62				55	40	80	92			
E10/US 0.75" N44X62	1.5"	0.75"			62				55	40	80	92			

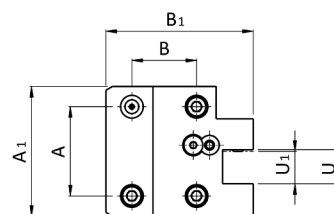
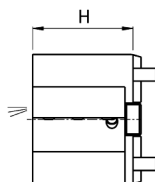
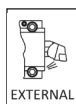
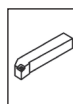
102/N44

Codice code - code - Bestell Nr.	U	U1	U2	U3	H	H1	H2	H3	A	B	A1	B1	A2	B2	B3
E10/UL 20 N44X62	21	20			62				55	40	80	91			
E10/UL 0.75" N44X62	21	0.75"			62				55	40	80	91			

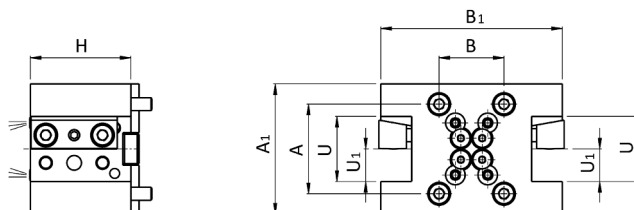
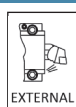
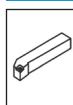
103/N44

Codice code - code - Bestell Nr.	U	U1	U2	U3	H	H1	H2	H3	A	B	A1	B1	A2	B2	B3
E10/UD 20 N44X62	40	20			62				55	40	80	112			
E10/UD 0.75" N44X62	1.5"	0.75"			62				55	40	80	112			

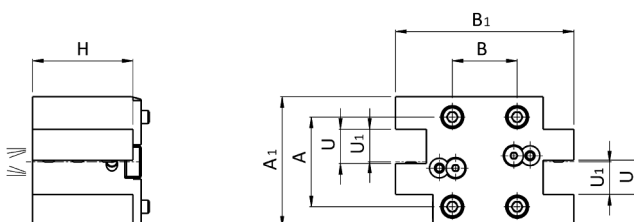
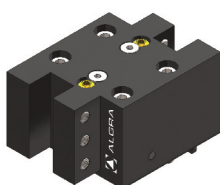
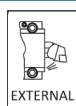
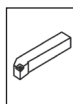
104/N44

Codice code - code - Bestell Nr.	U	U1	U2	U3	H	H1	H2	H3	A	B	A1	B1	A2	B2	B3
E10/ULD20 N44X62	21	20			62				55	40	80	110			
E10/ULD0.75" N44X62	21	0.75"			62				55	40	80	110			

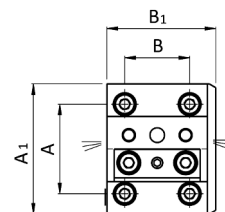
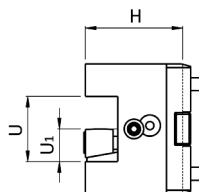

105/N44

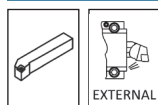

EXTERNAL

Codice code - code - Bestell Nr.	U	U1	U2	U3	H	H1	H2	H3	A	B	A1	B1	A2	B2	B3
E10/UA 20 N44X60	40	20			60				55	40	80	67			
E10/UA 0.75" N44X60	1.5"	0.75"			60				55	40	80	67			

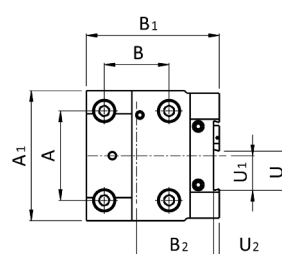
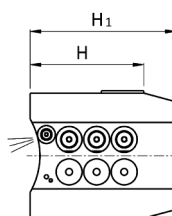

106/N44

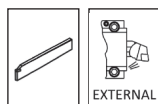

EXTERNAL

Codice code - code - Bestell Nr.	U	U1	U2	U3	H	H1	H2	H3	A	B	A1	B1	A2	B2	B3
E10/TT 26 N44X70	26	21	2,36		70	90			55	40	80	82		47,5	
E10/TT 32 N44X70	32	26	2,36		70	90			55	40	80	82		47,5	

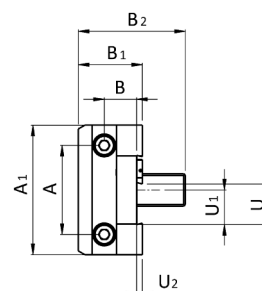
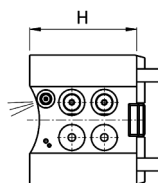

107/N44

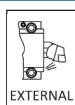
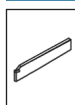

Codice code - code - Bestell Nr.	U	U1	U2	U3	H	H1	H2	H3	A	B	A1	B1	A2	B2	B3
E10/TTN26 N44X66	26	21	2,36		66				55	40	80	39,5		66	
E10/TTN32 N44X66	32	26	2,36		66				55	40	80	39,5		66	

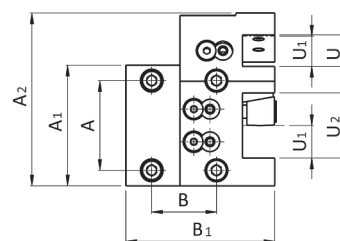
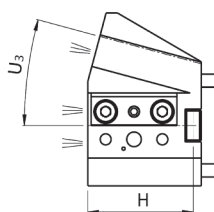

108/N44

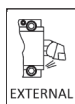
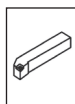

Codice code - code - Bestell Nr.	U	U1	U2	U3	H	H1	H2	H3	A	B	A1	B1	A2	B2	B3
E12/IDD20 N44X65	21	20	40	15°	65				55	40	80	92	106		
E12/IDD0.75" N44X65	21	0.75"	1.5"	15°	65				55	40	80	92	106		

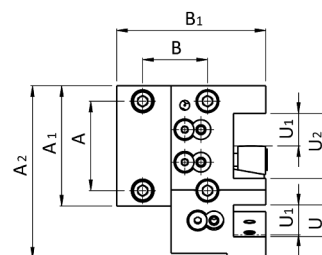
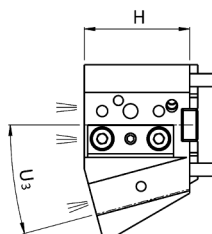
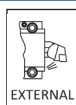
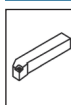
109/N44

Codice code - code - Bestell Nr.	U	U1	U2	U3	H	H1	H2	H3	A	B	A1	B1	A2	B2	B3
E12/IDS20 N44X65	21	20	40	15°	65				55	40	80	92	106		
E10/IDS0.75" N44X65	21	0.75"	1.5"	15°	65				55	40	80	92	106		

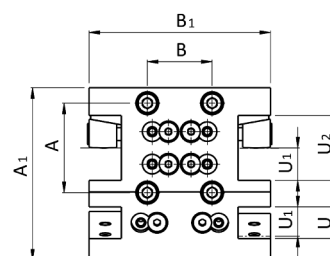
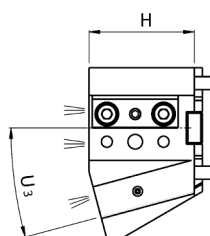
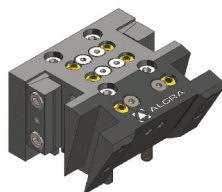
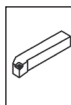
110/N44

Codice code - code - Bestell Nr.	U	U1	U2	U3	H	H1	H2	H3	A	B	A1	B1	A2	B2	B3
E12/IQ 20 N44X65	21	20	40	15°	65				55	40	106	112			
E12/IQ 0.75" N44X65	21	0.75"	1.5"	15°	65				55	40	106	112			

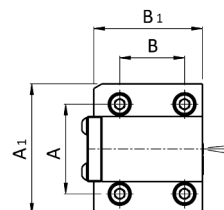
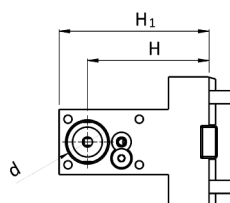

111/N44

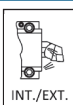
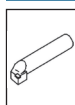

INT./EXT.

Codice code - code - Bestell Nr.	d	d1	d2	H	H1	H2	H3	A	B	A1	B1	A2	B2	B3
E10/B 25 N44X60	Ø 25			60	77,5			55	40	80	67			
E10/B 32 N44X60	Ø 32			60	85			55	40	80	67			
E10/B 20 N44X75	Ø 20			75	92,5			55	40	80	67			
E10/B 25 N44X75	Ø 25			75	92,5			55	40	80	67			
E10/B 32 N44X75	Ø 32			75	100			55	40	80	67			
E10/B 1" N44X75	Ø 1"			75	92,5			55	40	80	67			

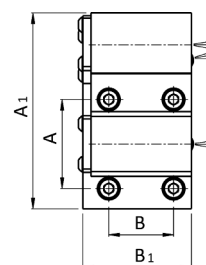
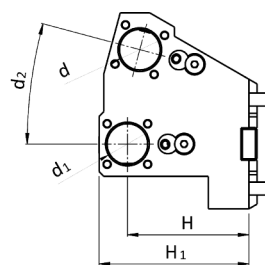
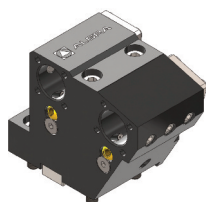

112/N44

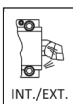
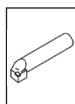

INT./EXT.

Codice code - code - Bestell Nr.	d	d1	d2	H	H1	H2	H3	A	B	A1	B1	A2	B2	B3
E12/IBD25 N44X75	Ø 25	Ø 25	15°	75	92,5			55	40	121	67			
E12/IBD1" N44X75	Ø 1"	Ø 1"	15°	75	92,5			55	40	121	67			



**La produzione:
il lavoro**

Production:
work

La produzione viene sviluppata nella moderna struttura a temperatura controllata di Almenno San Salvatore, mentre negli stabilimenti di Brembilla (I-Bergamo) vengono effettuate le lavorazioni di montaggio ed assemblaggio di gruppi completi. La superficie coperta delle strutture è di mq. 15.000, dei quali mq. 1.000 sono adibiti agli uffici amministrativi, commerciali e tecnici. L'attività produttiva si svolge con l'utilizzo di impianti e macchinari CNC costantemente aggiornati alle nuove tecnologie ed in grado di sviluppare le seguenti lavorazioni:

- Asportazione di truciolo
- Elettroerosione
- Tornitura orizzontale e verticale
- Fresatura universale 5 assi
- Fresatura/tornitura
- Lappatura per fori e piani
- Rettifica in tondo interno ed esterno
- Rettifica in tangenziale oltre al montaggio di gruppi e sottogruppi completi.

The production is developed in the modern, temperature controlled facility in Almenno San Salvatore, with Brembilla factories there are the assembly operations and the assembly of complete groups. The facilities covered area is of 15,000 sqm., 1,000 sqm. of which are used for the administrative commercial and technical offices. The production cycle takes place with the use of CNC fixtures and equipment constantly updated with new technologies and able to develop the following machining:

- Chip machining
- Electroerosion
- Horizontal and vertical turning
- 5-axis universal milling
- Milling/turning
- Lapping for holes and plane surfaces
- Cylindrical internal and external grinding
- Tangential grinding in addition to the assembly of complete groups and subassemblies.

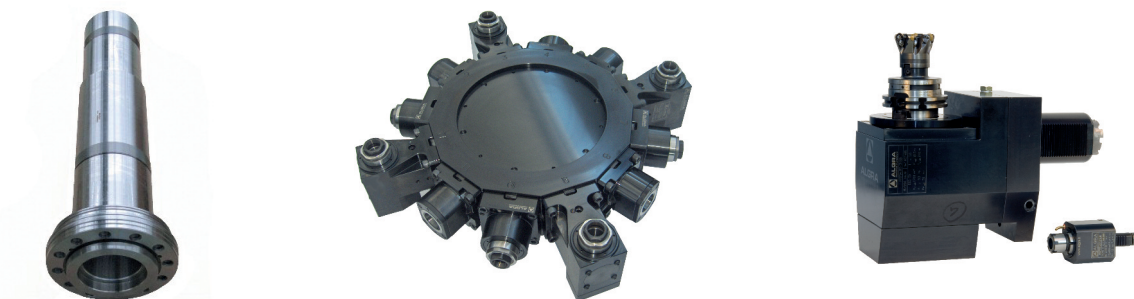
**Certificazioni:
uno standard
qualitativo**

Certification:
a quality
standard

La tecnologia avanzata svolge un ruolo chiave nell'obiettivo di incrementare il proprio valore, quello dei propri prodotti, dei servizi e della capacità del personale, operando nel rispetto delle norme UNI EN ISO 9001:2008 e ISO 14001:2004. L'alto livello di sensibilità verso il rispetto delle regole di sicurezza e dell'ambiente è presente ed immediatamente percepito in tutte le strutture aziendali.

Advanced technology plays a key role aiming to increase its value and the products, services and staff capacity value, operating in compliance with UNI EN ISO 9001:2008 and ISO 14001:2004.

The high level of sensitivity towards the observance of safety rules and the environment is present and perceived immediately in all facilities.



UNI EN ISO 9001:2008 - Cert. n° 0141



UNI EN ISO 14001:2004 - Cert. n° 0270A





ALGRA S.p.A. Divisione accessori
Via Manzoni, 41 24031 Almenno S. Salvatore (BG)
Tel. +39 035.64.20.51 • Fax +39 035.64.01.28
algra.accessori@algra.it - www.algra.it